

## 50-S-60 - SPEEDLINE System Data Sheet - Version V1 (24-10-23)

SPEEDLINE 50mm 'C' Stud Partition @600mm Ctrs,  
with 2x Siniat GTEC 15mm dB Board each side

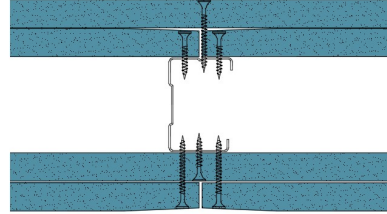

### System Performance Breakdown

Fire Resistance:

BS476 Part 22:1987:

Test Ref & Date or Applied Ref & Report:

Max Height:

Thickness:

Duty Grade: BS 5234: Part 2:1992:

Sound Insulation:

**90/90 Minutes** (Integrity/Insulation).

**BRE-P100456-1085 - BRE Report P102396-1011C**

**Refer to Speedline Specification Clause**

**112 mm.** (At Base Track, Excluding Finishes)

**Severe - Annexes A-F**

**47  $R_w$ dB**, Date Tested or Assessed Against - 50-S-59

Test Code:  
H17504AA  
Test Date:  
27/07/2011

Freq. Hz	R dB
50	23.3
63	17.5
80	14.4
100	19.6
125	21.8
160	32.5
200	38.0
250	37.4
315	41.7
400	47.4
500	52.0
630	52.7
800	56.2
1 000	58.4
1 250	61.3
1 600	63.5
2 000	58.3
2 500	48.9
3 150	50.5
4 000	54.9
5 000	56.0
6 300	
8 000	
10 000	

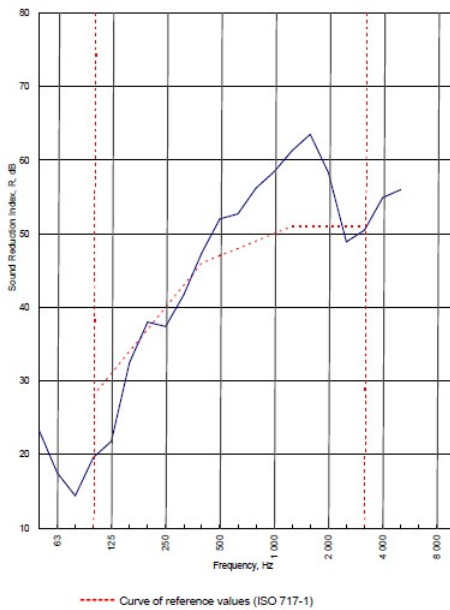

Rating according to BS EN ISO 717-1:1997  **$R_w$  (C;Ctr) = 47 (-3;-10) dB**  
 Max dev. 9.2 dB at 125 Hz  
 Evaluation based on laboratory measurement results obtained by an engineering method:  
 $C_{50-3150}$  = -5 dB     $C_{50-5000}$  = -4 dB     $C_{100-5000}$  = -2 dB  
 $C_{125-3150}$  = -15 dB     $C_{125-5000}$  = -15 dB     $C_{100-5000}$  = -10 dB

TESTED AT ONE OF THE UKAS ACCREDITED LABORATORIES BELOW

B.T.C (H-Ref on Graph) 

B.R.E 

AIRO 

S.R.L 

Customer: Metsec plc Hepsec Division



BTC 17504A: Page 8 of 10